

# EPOS

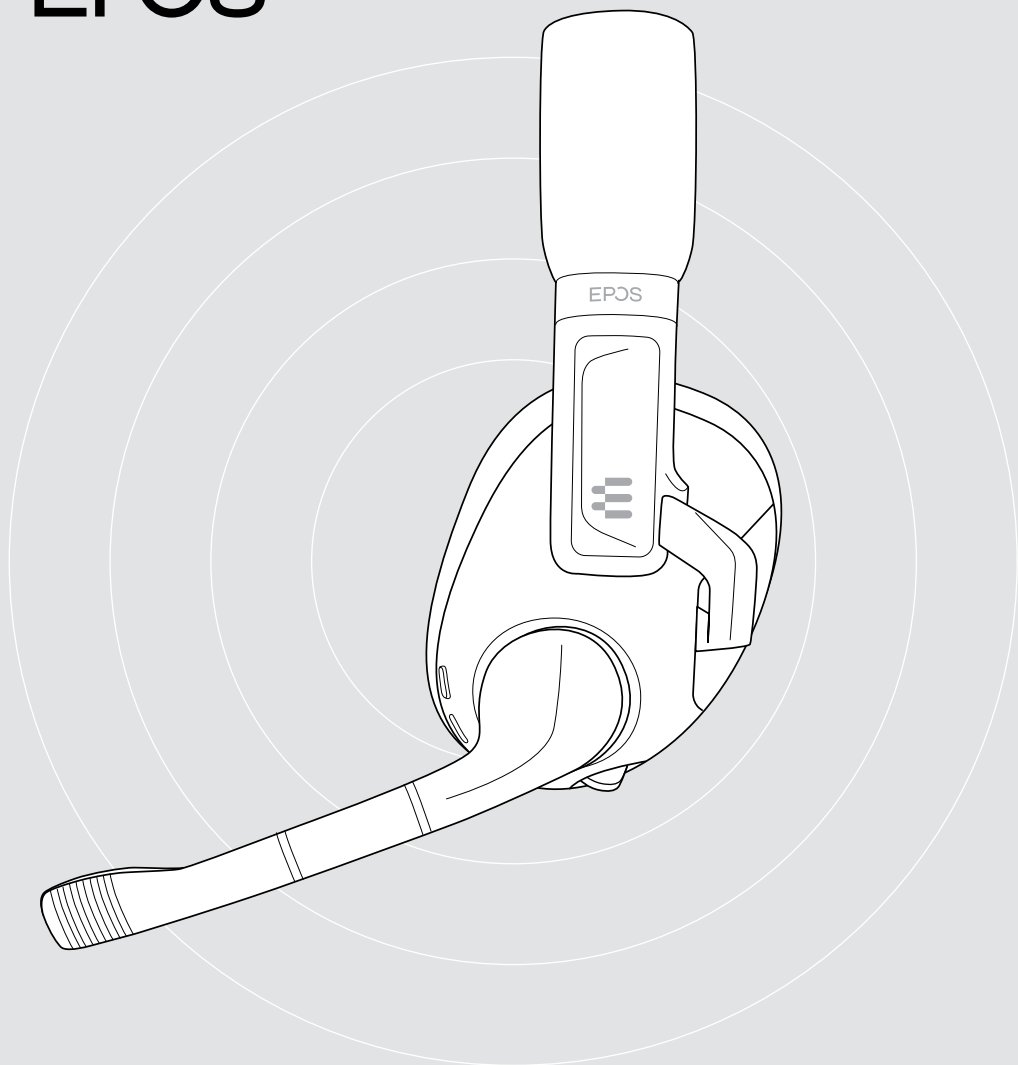

## H3 Hybrid

USB Gaming Headset with Bluetooth®

Model: SCBT25

**User Guide**

# Contents

Welcome .....	2
Package contents .....	3
H3 Hybrid at a glance .....	4
Headset at a glance.....	4
Icons at a glance.....	5
Getting started .....	6
Connection possibilities .....	6
A Connecting to PC via USB & charge the battery .....	7
B Connecting via audio cable.....	8
C Pairing the headset via Bluetooth .....	9
Installing the EPOS Gaming Suite.....	11
Changing audio settings – Microsoft® Windows.....	11
Individually adjusting the headset.....	12
How to use – the basics.....	13
Switching the headset on - auto connect.....	13
Mixing audio: two devices connected.....	15
Changing the volume.....	16
Muting the headset’s microphone .....	17
Handling calls.....	18
Activating surround sound or presets.....	19
Using the headset on the go.....	20
Switching the headset off .....	22
Charging and storing the headset.....	23
Good to know.....	25
Verifying remaining battery power.....	25
If you leave the Bluetooth range .....	26
Adjusting the sidetone.....	27
Maintaining & updating product.....	28
Cleaning the product.....	28
Replacing the ear pads.....	29
Updating the firmware .....	30
Replacing/removing the rechargeable battery .....	30
If a problem occurs.....	31
Clearing the pairing list of the headset (Reset).....	32
Specifications.....	33

# Welcome

## Wired, Bluetooth® or both, your choice

The EPOS H3 Hybrid gaming headset provides wired connectivity with USB/console cables and a simultaneous Bluetooth® connection for the gamer seeking multiple connectivity options in a high-quality headset.

Designed for lightweight comfort, a slider with length indicators is built into the headband for easy adjustment of the headset.

Hinged ear cups with ergonomically shaped ear pads angle to fit any face shape.

The main microphone in the detachable boom arm delivers crisp intelligible game chat while a secondary microphone in the ear cup allows calls while the boom arm is removed.

Download the EPOS Gaming Suite and play with 7.1 surround sound on the PC.

When paired with a smart phone, simultaneous Bluetooth® connectivity lets you chat with your friends if waiting for a match while gaming.

## Key benefits & features

### Multiple connection options

Wired USB PC gaming headset with analog console and Bluetooth® options

### EPOS audio technology

EPOS engineered game audio delivers the cues for instant game reactions

### EPOS Gaming Suite

Enhance your audio experience in the EPOS Gaming Suite for Microsoft® Windows 10

### Audio mixing

Mix audio streams from wired USB/cable and simultaneous Bluetooth® connections

### Magnetic detachable boom arm

Detach and re-attach the boom arm microphone easily with the magnetic connection



For safety instructions, consult the Safety Guide.

# Package contents

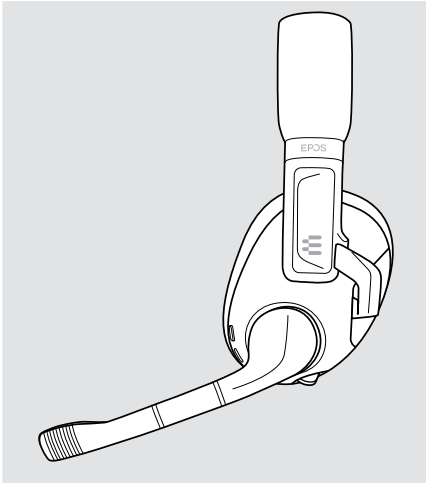

**H3 Hybrid**  
USB Gaming Headset with Bluetooth

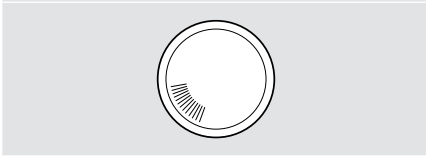

**On-the-go cover plate**  
instead of boom arm

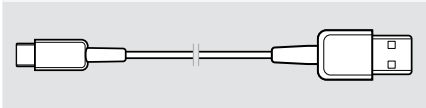

**USB cable**  
USB-C® to USB-A plug

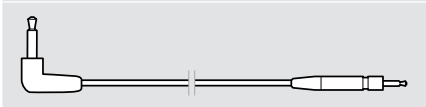

**Audio cable**  
2.5 mm to 3.5 mm jack plug



Quick Guide  
Translation Sheet  
Safety Guide  
Compliance Sheet







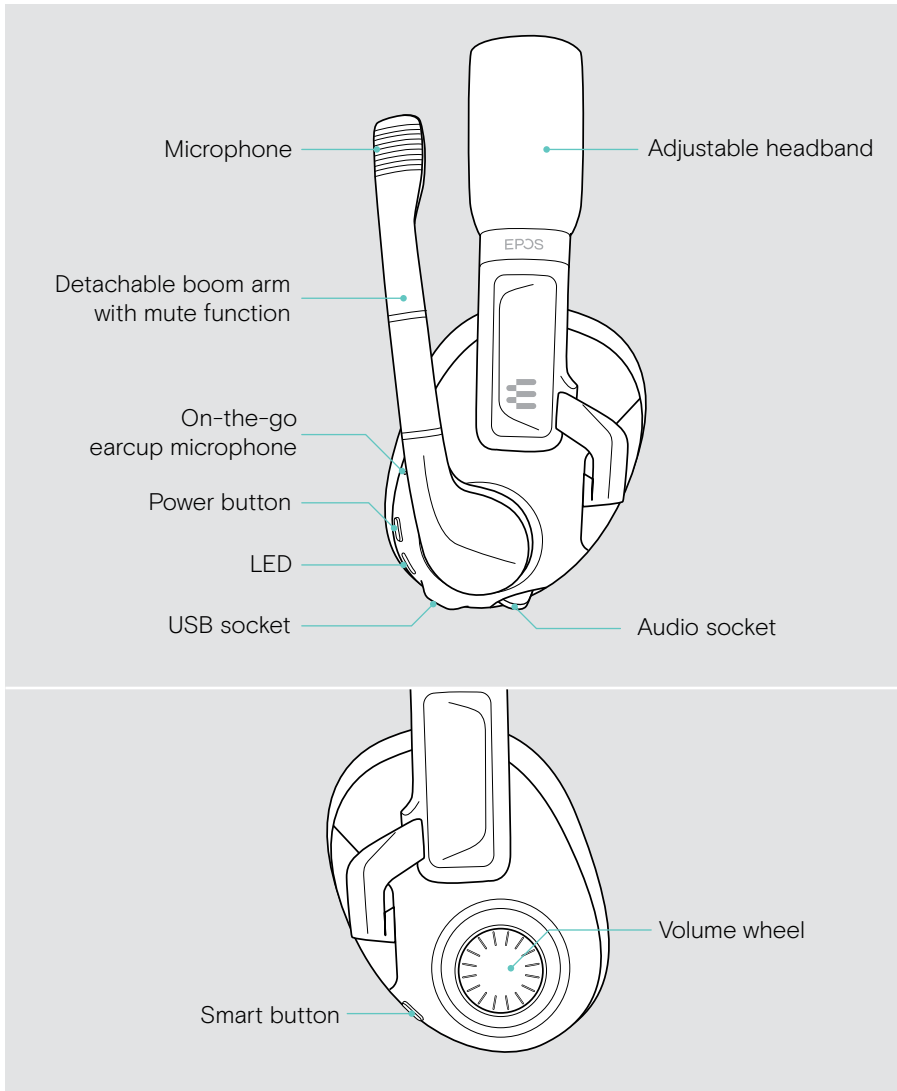

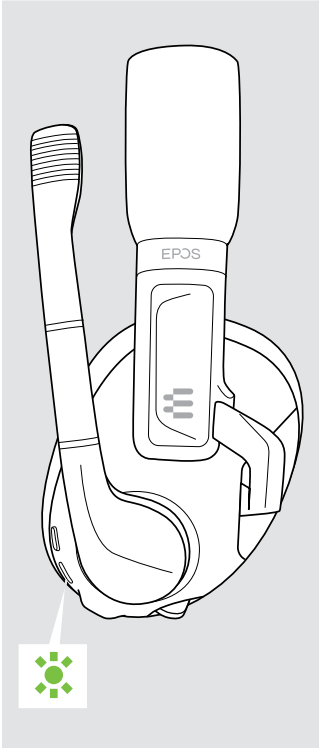

# H3 Hybrid at a glance

## Headset at a glance







---



## Overview of the headset LED

Headset	LED	Meaning
		Headset switches on
		Headset is in pairing mode
		Pairing to mobile device was successful Once the headset is successfully connected, the LED goes off.
		Headset switches off
		Pairing has failed or has been cancelled
		Rechargeable battery is weak
		Headset is being charged: color indicates battery status;
		LED goes off when fully charged
		
	Pairing list has been cleared	

## Icons at a glance

	Tap the button		Notes: Good to know
	Press the button twice		LED indications
	Press and hold the button		Voice prompt is announced

# Getting started

## Connection possibilities

---

You can connect the headset:

- **A** via the **USB cable** to a PC or PlayStation® PS5™ / PS4™ **or**
- **B** via the **audio cable** to a Nintendo Switch™, PlayStation® PS5™ / PS4™, Xbox® One & Series X/S **or**
- **C** via **Bluetooth** to a mobile device (e. g. smartphone, tablet)

You can also mix the audio from two sources – see page 15.



**A** If you connect the headset via USB cable it will automatically be charged.

## A Connecting to PC via USB & charge the battery

- > Connect the small plug of the USB cable to the headset's USB socket.
- > Connect the other plug to a **USB-A** socket of your PC.  
The headset switches on automatically. The LED flashes green 3 times. You hear a remaining battery power voice prompt – see page 25. The battery is being charged. The LED pulses slowly to indicate the battery status.
- > Change the audio settings – if required – and install the EPOS Gaming Suite (see next chapter).

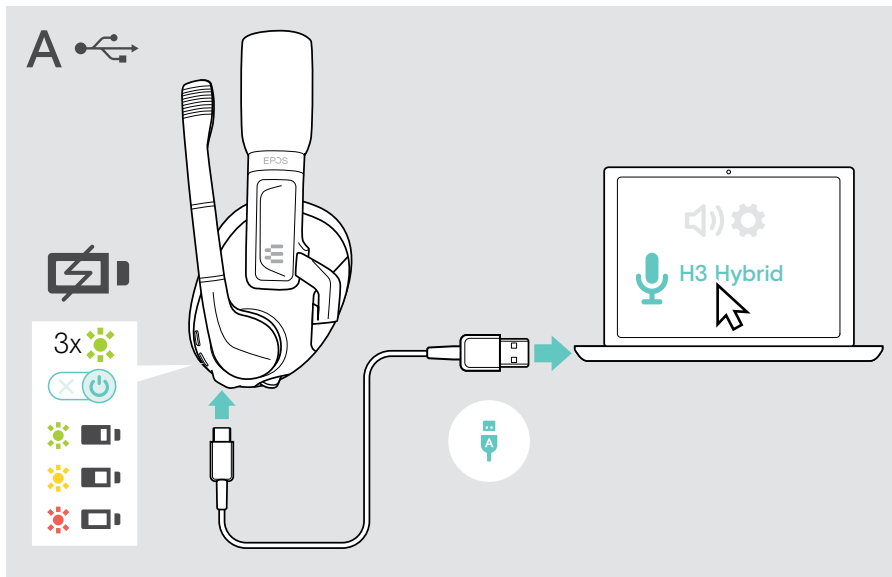

To disconnect the USB cable:

- > Pull the plugs out of the headset and your device. The headset switches off automatically – unless there is an already established Bluetooth connection.



## B Connecting via audio cable

The audio cable is mainly used for:

- Nintendo Switch™
- PlayStation PS5™ / PS4™
- Xbox® One & Series X/S

To connect the audio cable:

- > Insert the small jack plug into the audio socket of the headset. Make sure, that the marking on the plug disappears in the socket.
- > Connect the 3.5 mm jack plug to the audio socket of your device.
- > Press the power button to switch the headset on (see page 13).

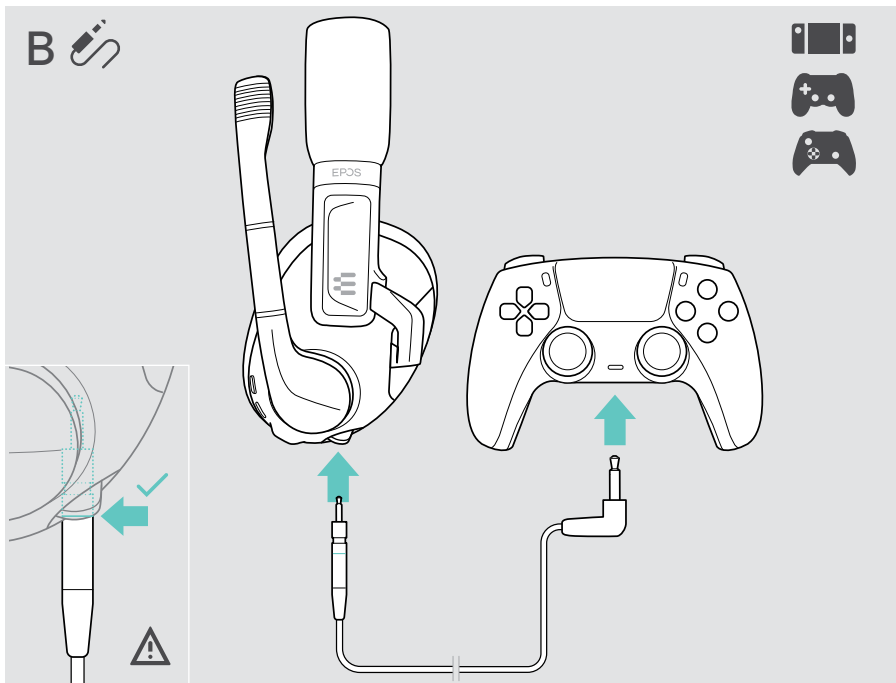

To disconnect the audio cable:

- > Pull the plugs out of the headset and your device.

## C Pairing the headset via Bluetooth



### CAUTION

#### Danger of malfunction!

The transmitted radio waves of mobile devices can impair the operation of sensitive and unprotected devices.

- > Only make calls with the headset in locations where wireless Bluetooth transmission is permitted.

The headset complies with the Bluetooth 5.2 standard. Bluetooth devices need to support the “advanced audio distribution profile” (A2DP).

You can connect the headset via Bluetooth to mobile devices (e. g. smartphone, tablet).

The headset can save up to eight paired devices. If you pair the headset with a ninth device, the first device in the pairing list will be overwritten. If you want to re-establish a connection with this device, you have to pair it again.

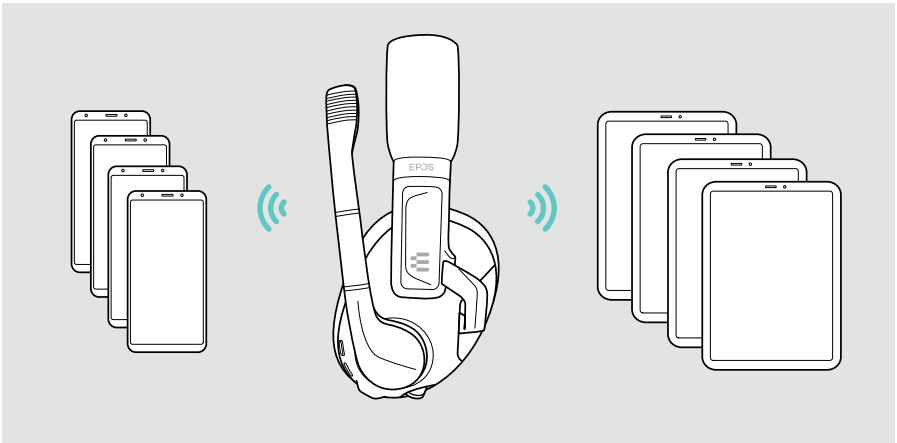

You can pair up with more devices, but only be connected to one Bluetooth device at a time.

## Pairing the headset via Bluetooth with a mobile device

- 1 Press the power button to switch the headset on.
- 2 Press the smart button until the LED alternately flashes blue and red (pairing mode).
- 3 Search for Bluetooth devices and select **EPOS H3 Hybrid** to establish the connection – see instruction manual of your mobile device. Once the headset is paired with the mobile device, the LED goes off.

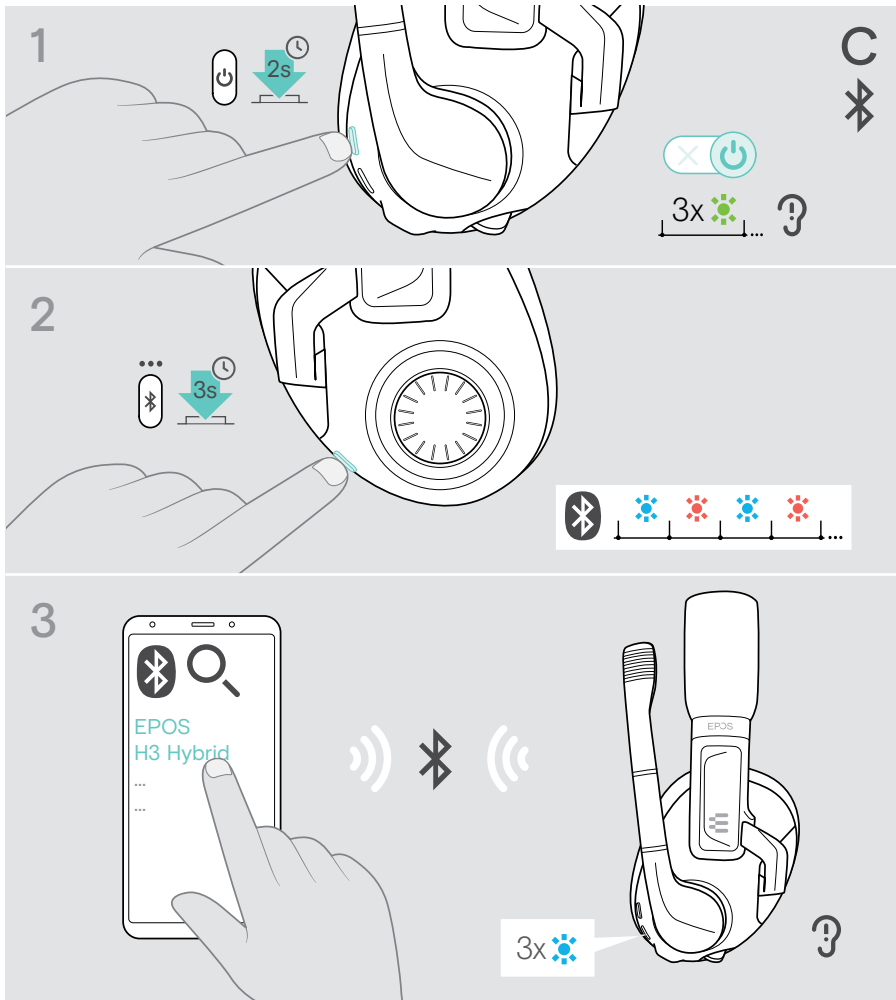

To cancel pairing:  
 > Press the smart button once.

## Installing the EPOS Gaming Suite

The free software **EPOS Gaming Suite** allows you to add value to your headset. The software is only available for Microsoft® Windows.

It enables headset configurations e. g. of the smart button, equalizer, sidetone, noise reduction and update of your devices.

- > Download the software from [www.eposaudio.com/gaming/downloads](http://www.eposaudio.com/gaming/downloads).
- > Install the software.

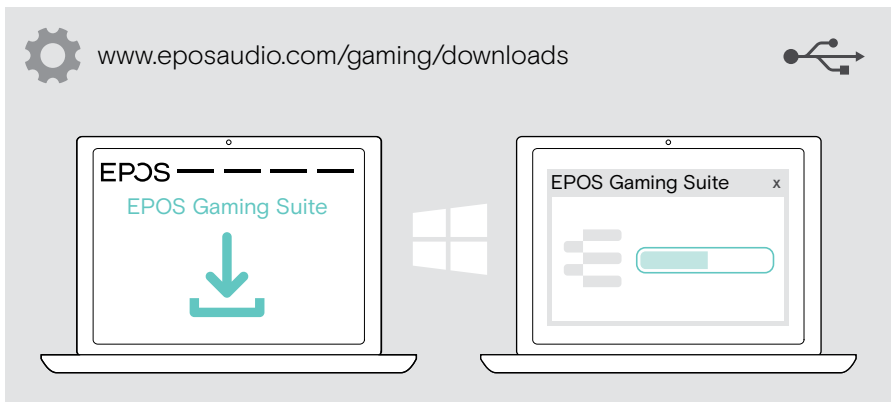

## Changing audio settings – Microsoft® Windows

Windows usually changes the audio settings automatically if you connect the USB cable. If the headset is connected but you hear no sound:

- > Right-click the audio icon.
- > Select under output **EPOS H3 Hybrid** as main audio.

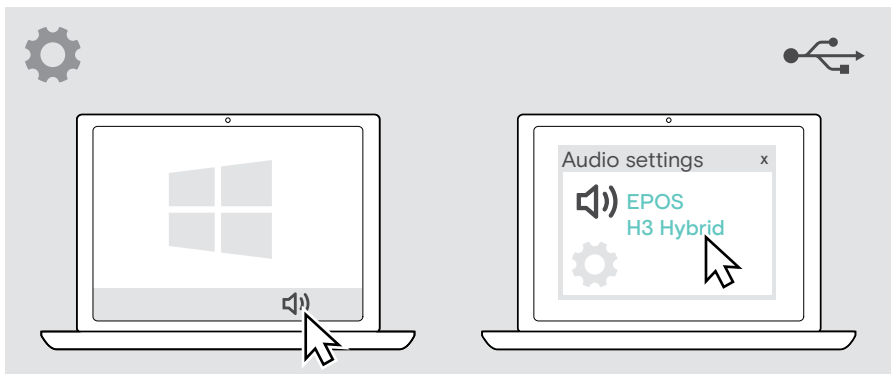

## Individually adjusting the headset

For good sound quality and best possible wearing comfort, the headset has to be adjusted to properly fit your head.

- > Wear the headset so that the headband runs over the top of your head.

### Adjusting the headband and the boom arm

- > Adjust the headset so that
  - your ears are comfortably covered by the ear pads,
  - you feel even, gentle pressure around your ears,
  - a snug fit of the headband on the head is ensured.
- > Bend the microphone boom so that the microphone is in line with your mouth and about 0.8" (2 cm) from the corner of your mouth.

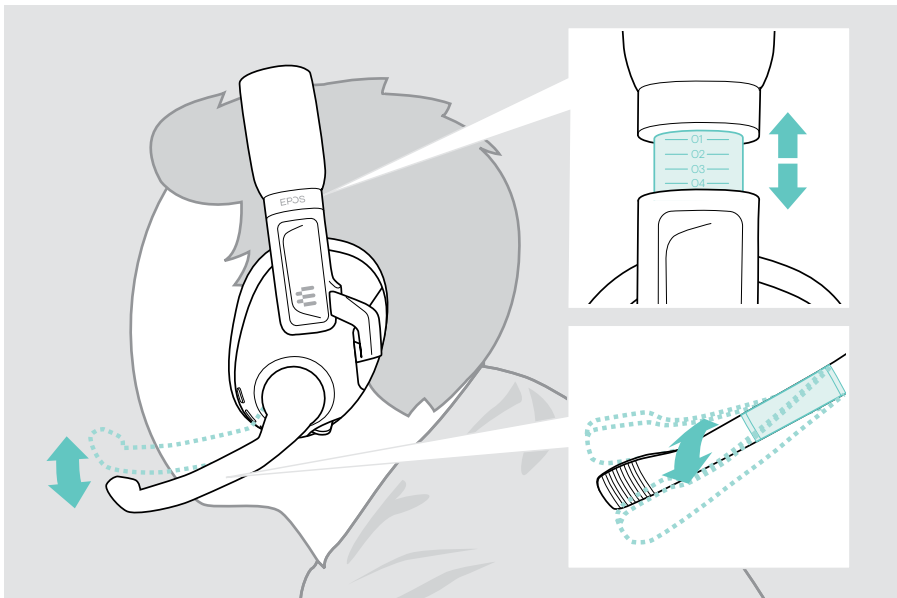

# How to use – the basics



## CAUTION

### Risk of hearing damage!

Listening at high volume levels for long periods can lead to permanent hearing defects.

- > Set the volume to a low level before putting on the headset.
- > Do not continuously expose yourself to high volumes.

## Switching the headset on – auto connect



The headset switches on **automatically**, if you connect it via the **USB cable**.

For all other connections:

- > Press the power button to switch the headset on.  
The LED flashes 3 times green. You hear a remaining battery power voice prompt – see page 25. The headset tries to connect to wireless devices automatically – see next chapter.

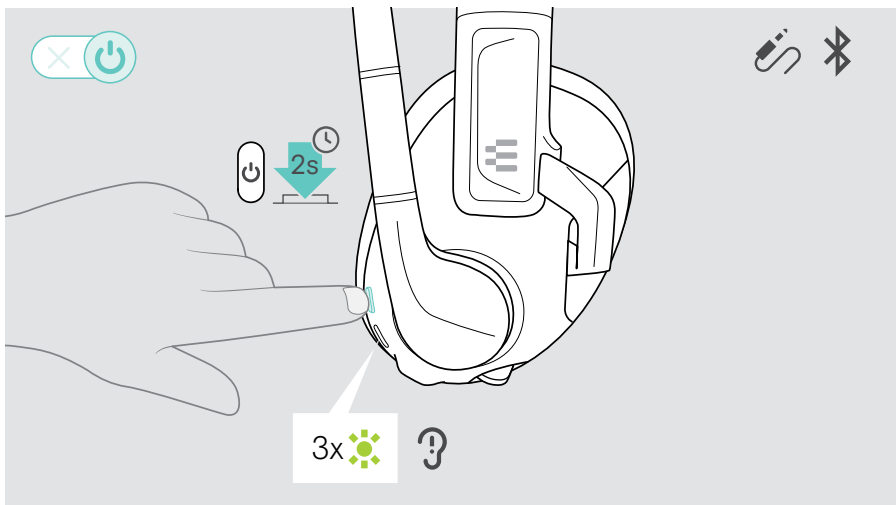

## Automatic wireless connection

After switch on, the headset automatically tries to connect to the latest used Bluetooth device. If this is not available the headset tries to find other paired devices.

Once the connection is successfully established, you hear a voice prompt and the LED flashes 3 times blue.

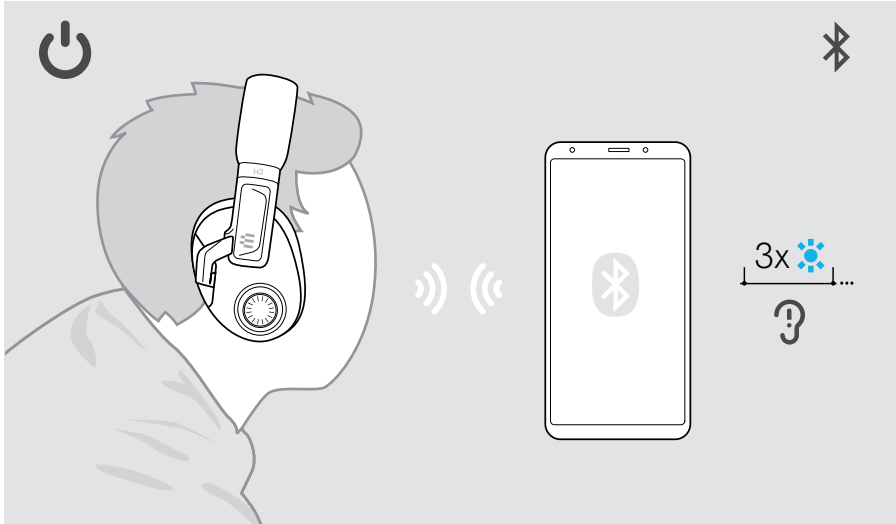

If the headset does not find a paired device to connect to, it automatically switches off after 30 minutes.

## Connecting wireless devices manually

After a while the automatic search ends. If you want to connect to your Bluetooth device after the automatic search has ended, you need to connect manually:

- > Activate **EPOS H3 Hybrid** in the Bluetooth devices list of your connected Bluetooth device **or**
- > Switch the headset off and on, to connect it to the last used device.

## Mixing audio: two devices connected

Audio mixing allows you to e. g. play your Game on one device and have a chat on the second device.

You can combine two audio sources:

1 **primary device**: Audio cable, USB connection and

2 **secondary device**: Bluetooth connection

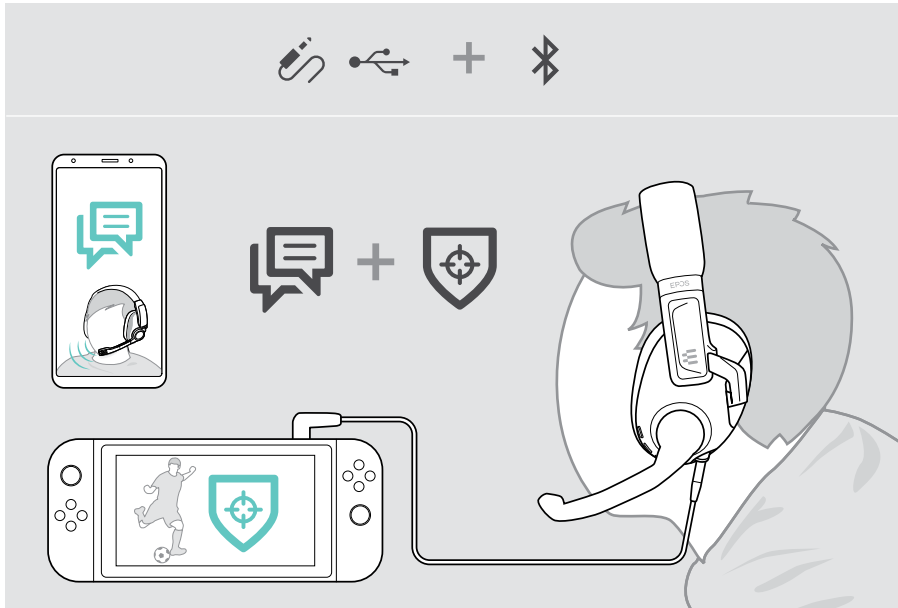



## Changing the volume

- > Turn the volume wheel
  - clockwise to increase or
  - counter-clockwise to reduce the volume.

Alternatively you can adjust the volume on your connected device.

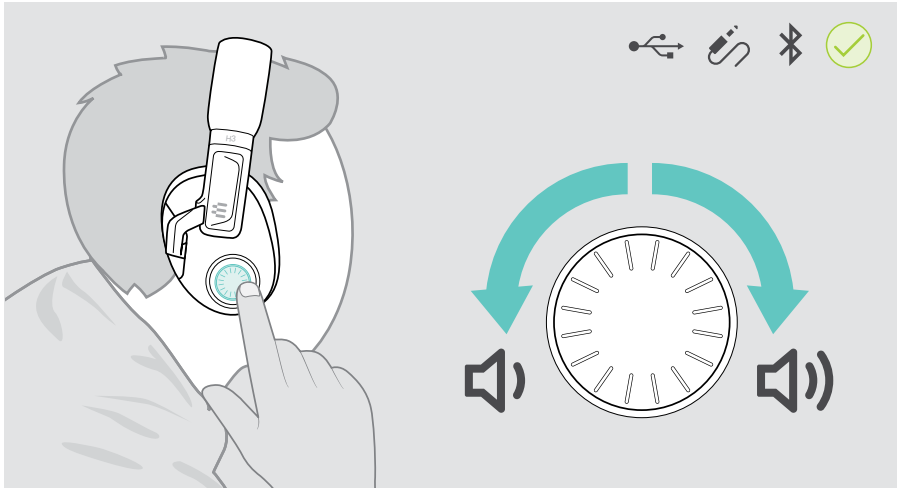

## Changing the volume while audio mixing

If you have two devices connected:

- > Turn the volume wheel to change the volume for the primary device (audio cable, USB).
- > Change the volume of your secondary Bluetooth device manually.

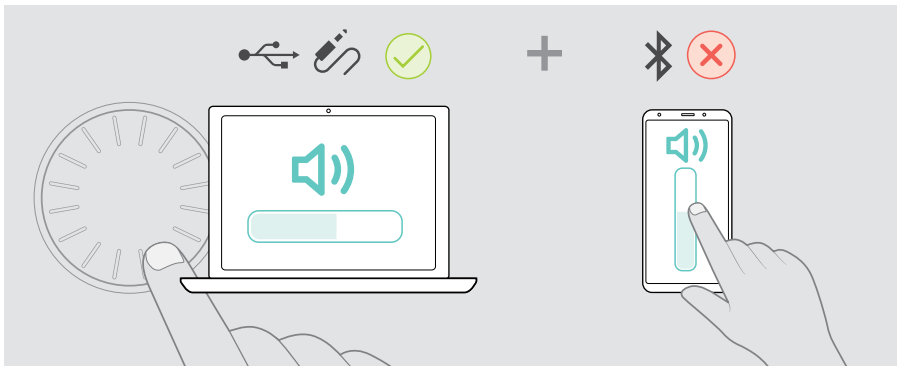

## Adjusting the headset's microphone volume for softphones

- > Initiate a call on your connected device to someone who will help you find the correct volume setting for your microphone.
- > Change the microphone volume in your softphone application and/or in your PC audio application.

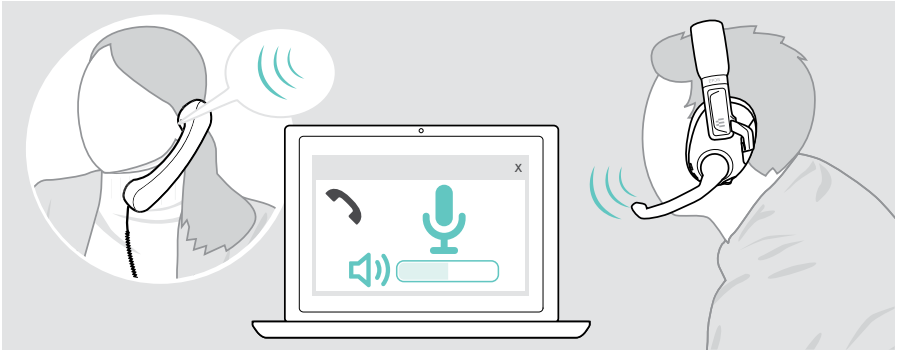

## Muting the headset's microphone

- > Move the boom arm
  - up until you hear a click to mute or
  - down to unmute the microphone.

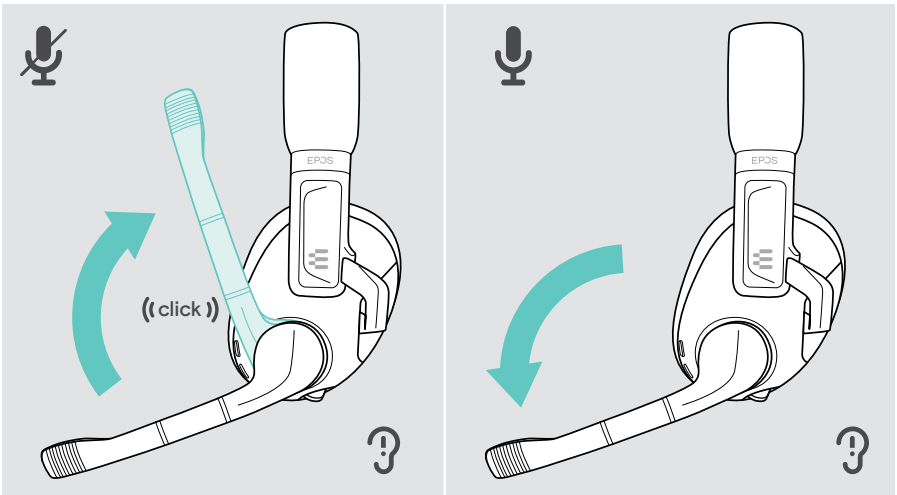

## Handling calls

You can handle calls of devices that are **connected via Bluetooth**. These functions are device and application dependent.

- > Initiate calls via your connected device.
- > Press the smart button:

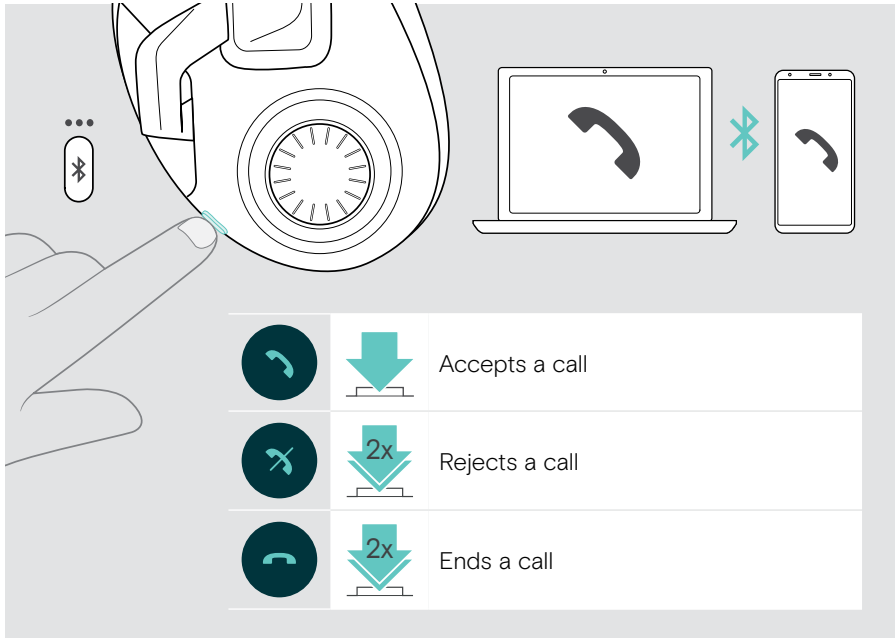

## Activating surround sound or presets

In addition to the call handling, you can activate additional functions for the smart button in the EPOS Gaming Suite (see page 11) to either **surround sound** or **preset switcher**.

To change the setting for the smart button:

- > Connect the headset to your PC (see page 7).
- > Change and save the settings for the smart button via EPOS Gaming Suite.





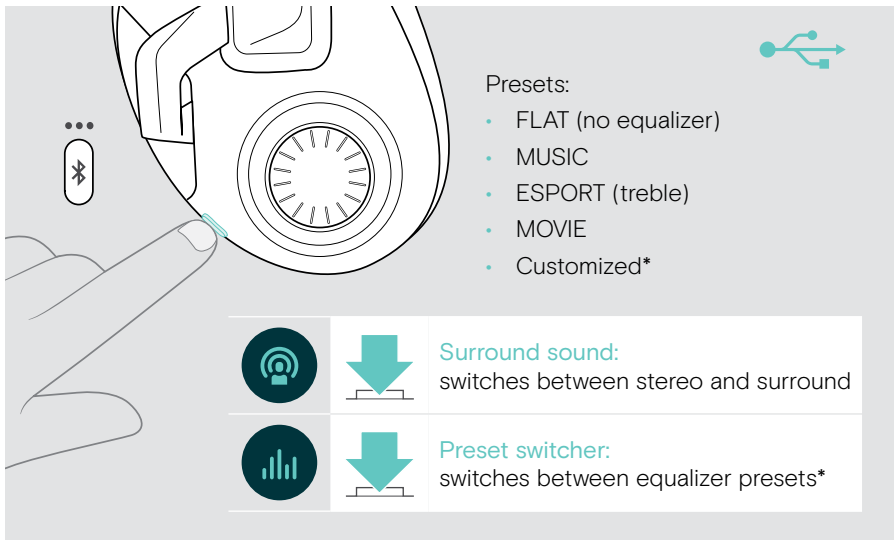

> Press the smart button:



Presets:

- FLAT (no equalizer)
- MUSIC
- ESPORT (treble)
- MOVIE
- Customized\*

		<b>Surround sound:</b> switches between stereo and surround
		<b>Preset switcher:</b> switches between equalizer presets*

\*Customized preset: You can also add your own preset in the EPOS Gaming Suite. For more information, visit [www.eposaudio.com/gaming](http://www.eposaudio.com/gaming).

## Using the headset on the go

If you want to use the headset on-the-go, you can detach the magnetic boom arm and replace it with the cover plate.

You can still make calls as the headset comes with a second microphone in the ear cup. This microphone can only be muted via your connected device.



### Replacing the boom arm with the cover plate

- > Grab the boom arm close to the ear cup and lift it. Do not pull on the bendable or microphone part.
- > Attach the magnetic cover plate.

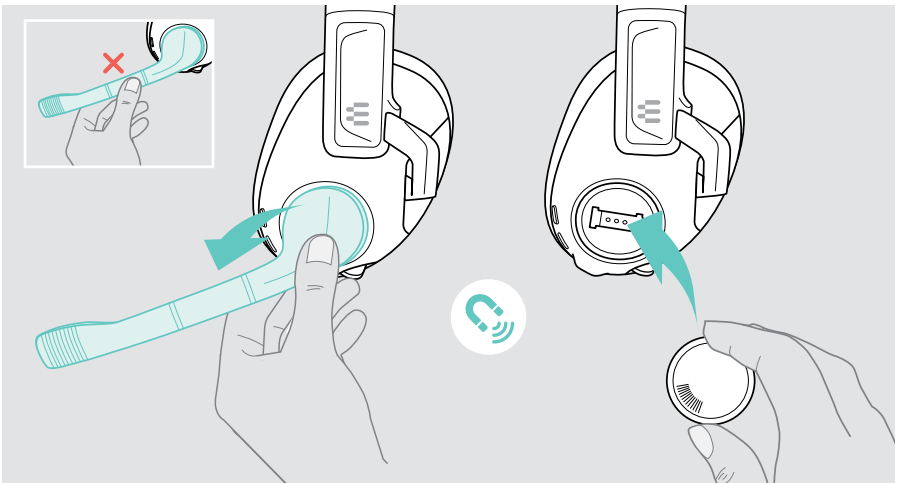

## Attaching the boom arm

- > Press on the markings of the cover plate to loosen it.
- > Attach the boom arm.

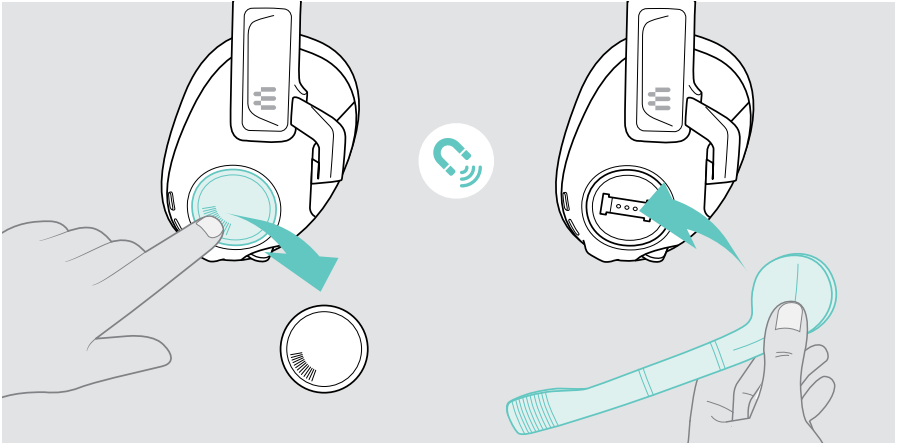

## Switching the headset off



The headset switches off **automatically**, if you disconnect the **USB cable** – unless there is a Bluetooth connection.

For all other connections:

- > Press the power button to switch the headset off.  
The LED flashes red 3 times and switches off. The voice prompt “power off” is announced in the headset.

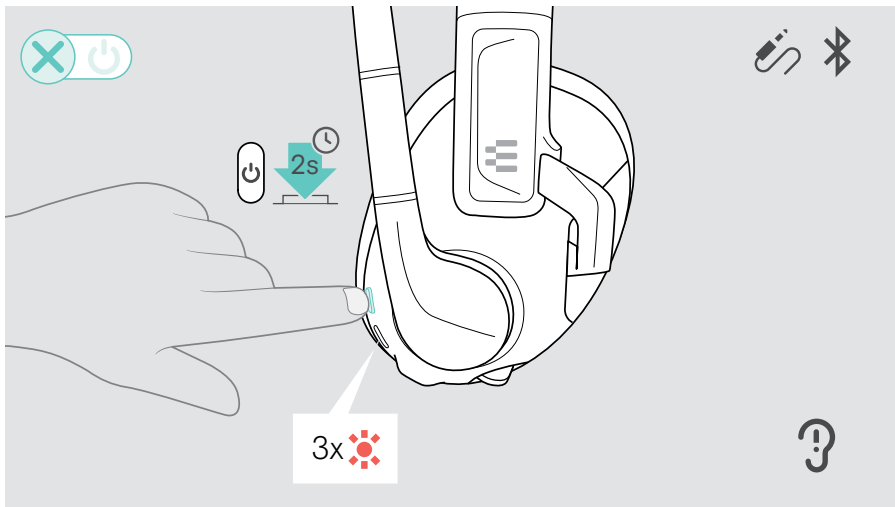

If the headset is connected wirelessly and there is no audio signal, it switches off after 30 minutes to save battery power.



## Charging and storing the headset

### Charging the headset

- > Connect the USB cable to your headset and your PC or PlayStation (see page 7) or a certified wall power supply\*.

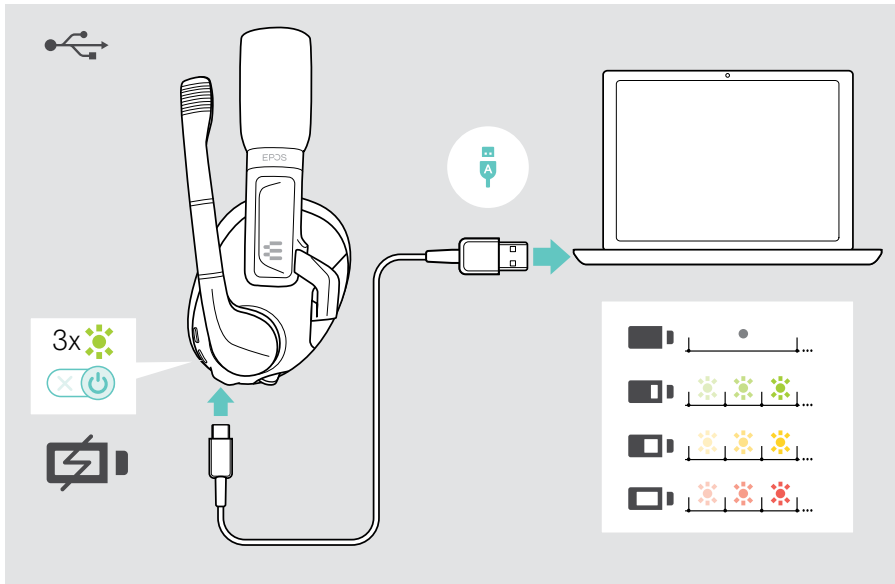
The headset switches on automatically. The battery is being charged. The LED pulses red, yellow or green – depending on the battery status and switches off when fully charged (approx. 1 hour 50 minutes).



  If the battery level of the headset gets low, the LED flashes red and the voice prompt “recharge headset” is announced several times. When the battery is flat, the headset switches off automatically.

\*Only use a USB power supply with maximum 5 V ±0.25 V.



## Storing the headset

- > Store the headset in a clean and dry environment.

The GSA 50 headset hanger is the perfect accessory for keeping your gaming headset conveniently out of sight, yet easy to reach. The hanger is available at [www.eposaudio.com](http://www.eposaudio.com).

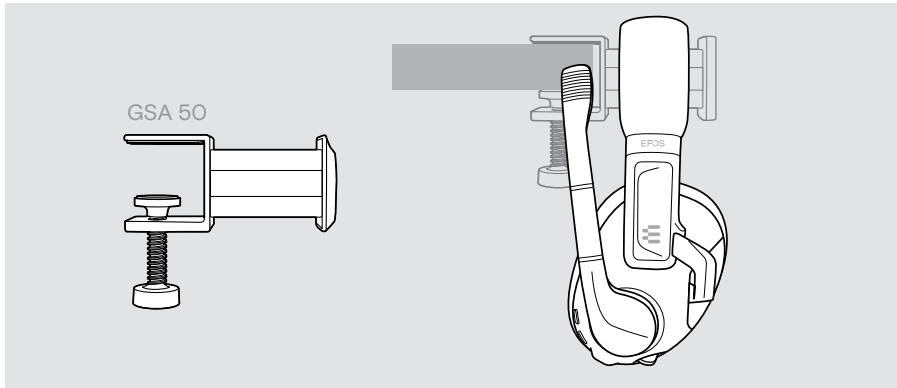

# Good to know

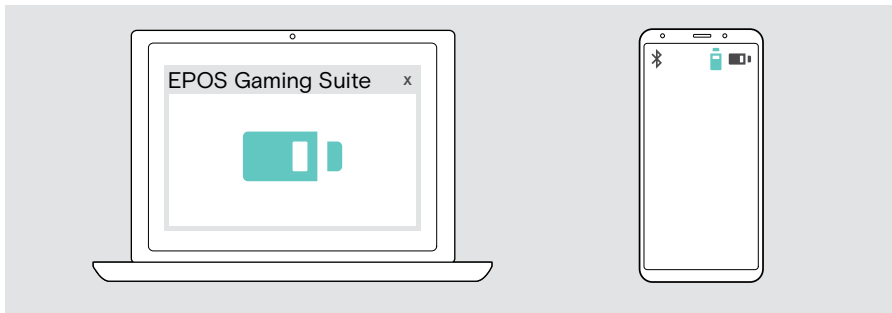

## Verifying remaining battery power

You can check the battery status of the headset in the EPOS Gaming Suite. Some mobile devices also indicate the battery status.



The battery status is given every time you switch on the headset or plug in the USB cable.

LED	Information announced	Battery power
	"More than 80 percent battery left"	> 80%
	"More than 60 percent battery left"	> 60%
	"More than 40 percent battery left"	> 40%
	"More than 20 percent battery left"	> 20%
	Automatic voice prompt: "Recharge headset" > Charge the headset (see page 23).	< 20%



 If the battery level of the headset gets low, the LED flashes red and the voice prompt "recharge headset" is announced several times. When the battery is flat, the headset switches off automatically.

## If you leave the Bluetooth range

---

The range between the headset and the connected device is device dependent. The transmission range largely depends on environmental conditions such as wall thickness, wall composition etc.

With a free line of sight, the Bluetooth transmission range is up to 15 meters.

If the audio quality gets worse or the link breaks down completely:

- > Re-enter the radio range of the Bluetooth device to re-connect.

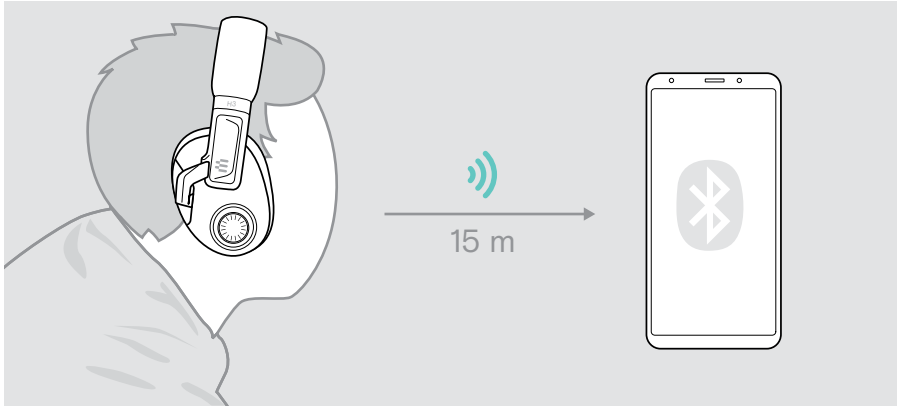

## Adjusting the sidetone

With the sidetone settings you can adjust the loudness of your own voice being played back in the headset.

- > Open the EPOS Gaming Suite (see page 11).
- > Change the sidetone setting.  
Your setting will be saved on the headset, so it is available for all other gaming platforms.

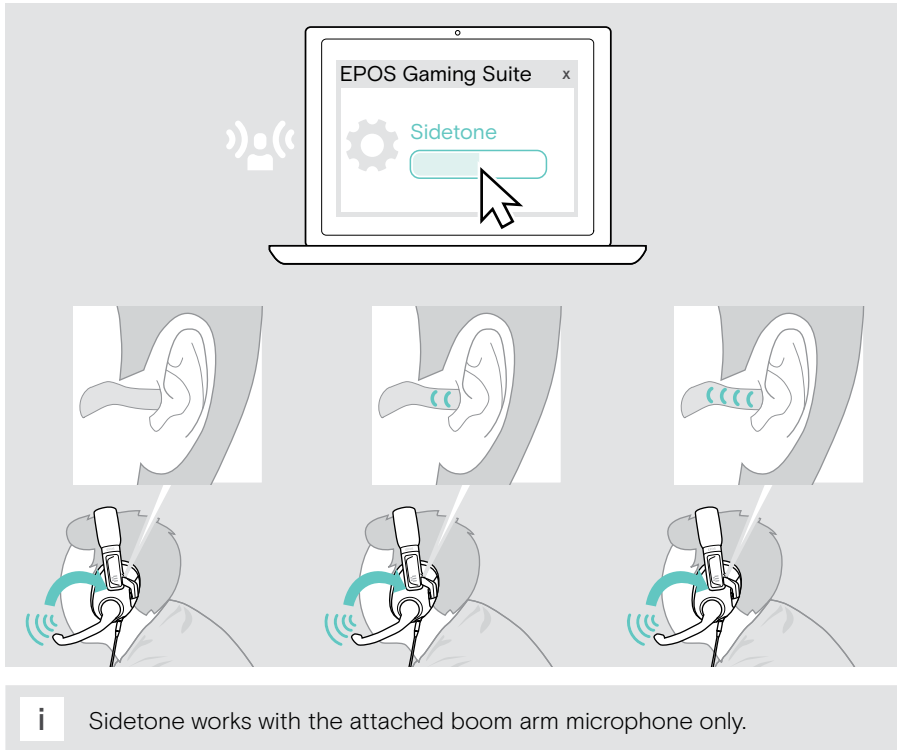

# Maintaining & updating product

## Cleaning the product

### CAUTION

**Liquids can damage the electronics of the product!**

Liquids entering the housing of the device can cause a short circuit and damage the electronics.

- > Keep all liquids far away from the product.
- > Do not use any cleansing agents or solvents.
- > Use a dry cloth to clean the product only.

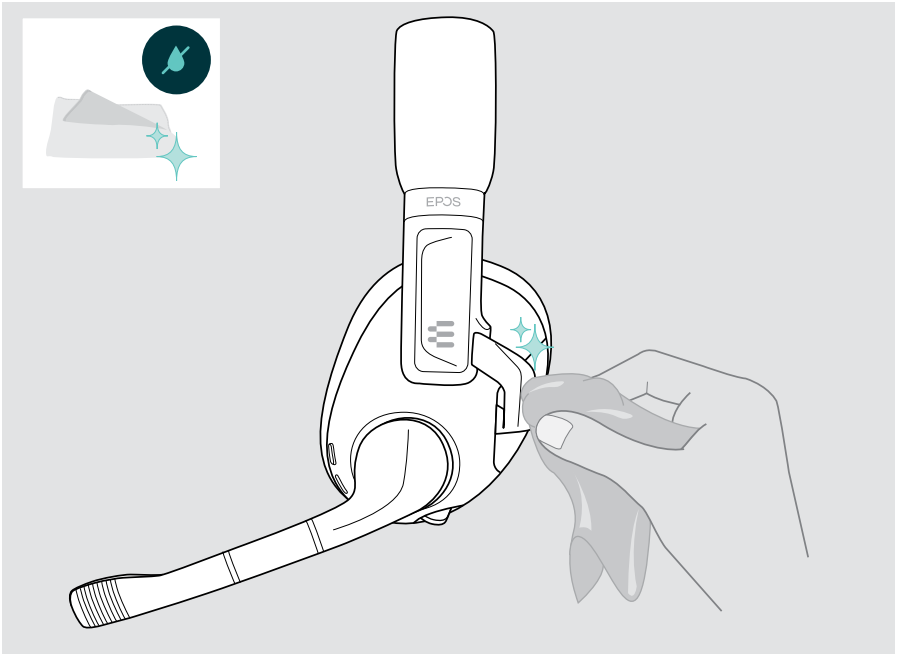

## Replacing the ear pads

---

For hygienic reasons, you should replace the ear pads from time to time. Spare ear pads are available from your EPOS partner.

- > Carefully remove the old ear pad from the ear cup.
- > Attach the new ear pad to the ear cup by pressing firmly around the ear pad.

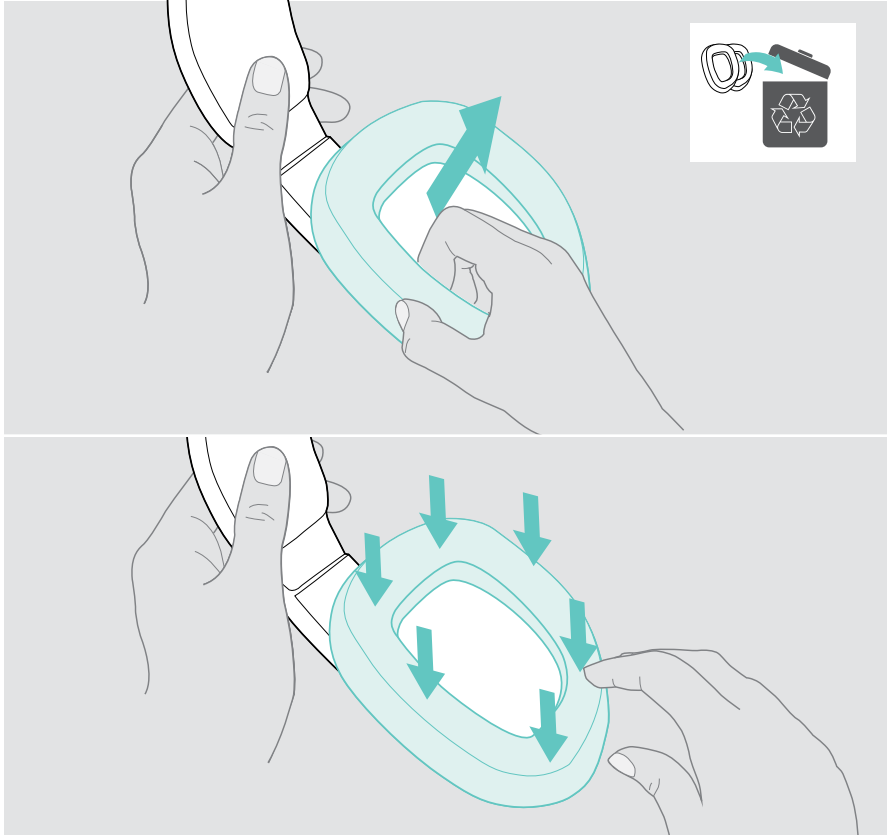

## Updating the firmware

---

You can update the firmware of your headset by using the free **EPOS Gaming Suite** software (see page 11).

- > Connect the USB cable to your headset and your PC.  
The headset switches on.
- > Start the **EPOS Gaming Suite**. If there is a new firmware available the software will guide you through the update process.

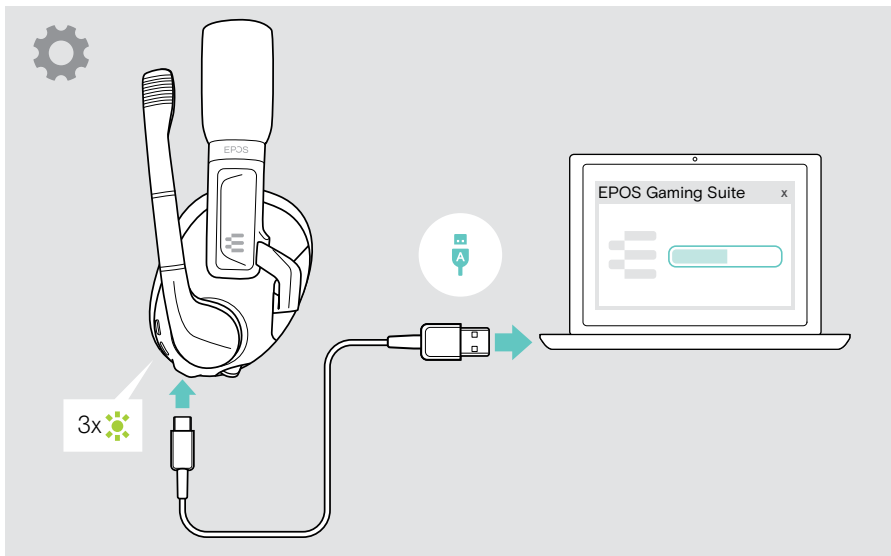

## Replacing/removing the rechargeable battery

---

The rechargeable battery must only be replaced or removed by an authorized EPOS service center.

- > Contact your EPOS service center if the rechargeable battery needs to be replaced. To find an EPOS service partner in your country, visit [www.eposaudio.com](http://www.eposaudio.com).

## If a problem occurs...

Problem	Possible cause	Solution	Page
Headset cannot be switched on	Rechargeable battery empty	> Recharge the headset battery.	23
No audio signal or drop outs	Headset not paired with a Bluetooth device	> Pair the headset.	9
	Volume adjusted too low	> Increase the volume on the headset or your connected device.	16
	Headset or connected device switched off	> Switch the headset or device on.	13
	Audio cable's plugs not fully inserted	> Insert the plugs again.	8
	USB cable's plugs not fully inserted	> Insert the plugs again.	7
Headset cannot be connected via Bluetooth	Headset not paired	> Pair the headset.	9
	Bluetooth at connected device turned off	> Turn Bluetooth on.	-
Headset cannot be switched off	Headset connected via the USB cable: auto on	> Disconnect the USB cable.	7
		> Switch the headset off.	22
Headset does not react to any button press	Software or hardware problems	> Switch the headset off and on again.	22 13
		> Clear the pairing list of the headset.	32
		To reset the headset: > Press the power and smart button at the same time. The headset LED flashes and the headset switches off.	-

If a problem occurs that is not listed here or if the problem cannot be solved with the proposed solutions, please contact your local EPOS partner for assistance.

To find an EPOS partner in your country, search at [www.eposaudio.com](http://www.eposaudio.com).



## Clearing the pairing list of the headset (Reset)

---

- > Press the power button to switch the headset on.
- > Press and hold the smart button until the LED alternately flashes blue and red (pairing mode).
- > Press the smart button again 2 times. The LED flashes purple 3 times.  
The pairing list is cleared. The headset tries to pair with wireless devices (see page 9).

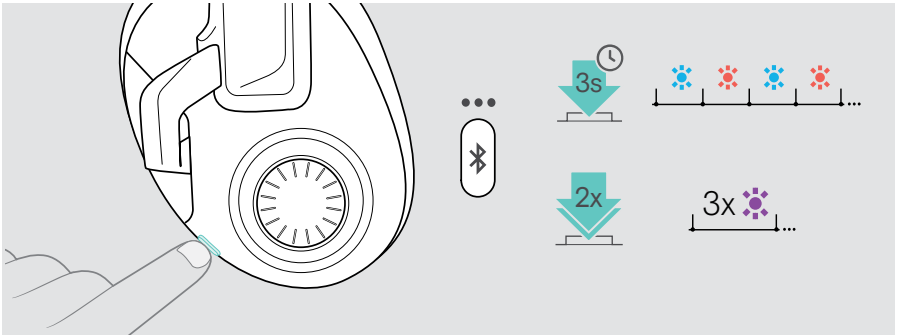

# Specifications

## H3 Hybrid headset

Dimensions (W x H x D)	183 x 176 x 90 mm/ 7.2 x 6.9 x 3.5 in
Weight	298 g / 0.66 lbs / 10.51 oz
Connector	<ul style="list-style-type: none"> <li>• Bluetooth</li> <li>• Console cable: 1 x 3.5 mm audio jack 4 pole; length: 1.5 m</li> <li>• USB-C to USB-A cable; length: 2 m</li> </ul>
Standby time	Bluetooth: up to 510 hours
Talk time via Bluetooth	up to 37 hours
Charging time	approx. 1 hour 50 minutes
Rechargeable battery (built in)	Lithium Polymer / 3.7 V / 335 mA
Charging voltage	max. 5.5 V / max. current 400 mA
Speaker principle	dynamic, closed
Frequency response	Headphone: 20 Hz - 20,000 Hz Microphone: 100 Hz - 7,500 Hz
Sensitivity headphone	116 dBSPL / OdBFS @ 1 kHz
Sensitivity microphone (detachable)	-20 dBFS/Pa @1 kHz (boom-arm) -22 dBFS/Pa @1 kHz (ear cup)
Total harmonic distortion (THD)	< 0.5 % OdBFS @ 1 kHz
Microphone type	Bi-Directional ECM
Microphone pick-up pattern	Bidirectional

## Bluetooth

Bluetooth	version 5.2 / class 1
Range	up to 15 m / 49.2 ft
Transmission frequency	2402 MHz to 2480 MHz

## Trademarks

The Bluetooth® word mark and logos are registered trademarks owned by Bluetooth SIG, Inc. and any use of such marks by DSEA A/S is under license.

USB Type-C® and USB-C® are trademarks of USB Implementers Forum.

“PlayStation®” is a registered trademark or trademark of Sony Interactive Entertainment Inc. also “PS5™”/“PS4™” is a trademark of the same company.

All other trademarks are the property of their respective owners.

# EPOS

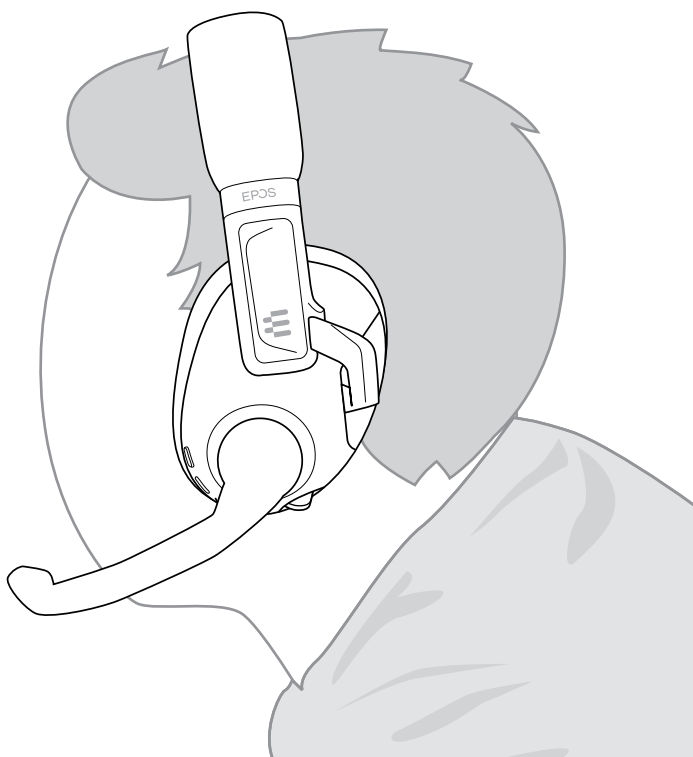
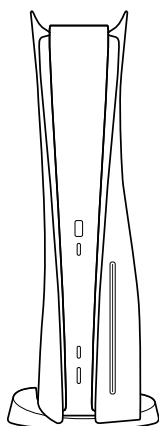
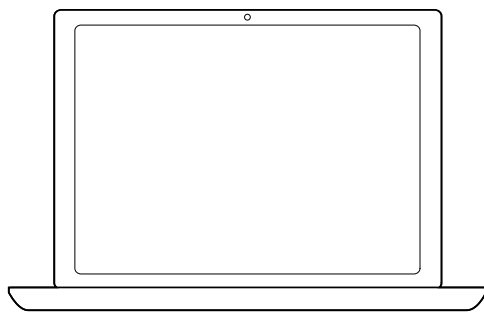
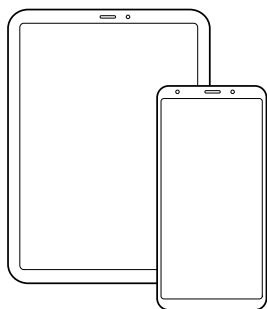

**DSEA A/S**

Kongebakken 9, DK-2765 Smørum, Denmark

[www.eposaudio.com](http://www.eposaudio.com)

Publ. 08/21, A01